

SPECIFICATION:

JOSAM SERIES 30000-WF ADJUSTABLE COATED CAST IRON WIDE FLANGE, INSIDE CAULK OUTLET (-X) BODY WITH NON-PUNCTURING MEMBRANE FLASHING COLLAR, WEEP HOLES AND THREADED TO RECEIVE JOSAM ADJUSTABLE STRAINER.

**FLOOR DRAIN
SPECIAL CONFIGURATION**

SERIES **30000-WF**

THIS DRAIN ASSEMBLY CAN BE USED WITH ALL 30000's STRAINERS AND ACCESSORIES LISTED IN THE STRAINER SECTION OF THE PRODUCT CATALOG

CONFORMS WITH ASTM-C564

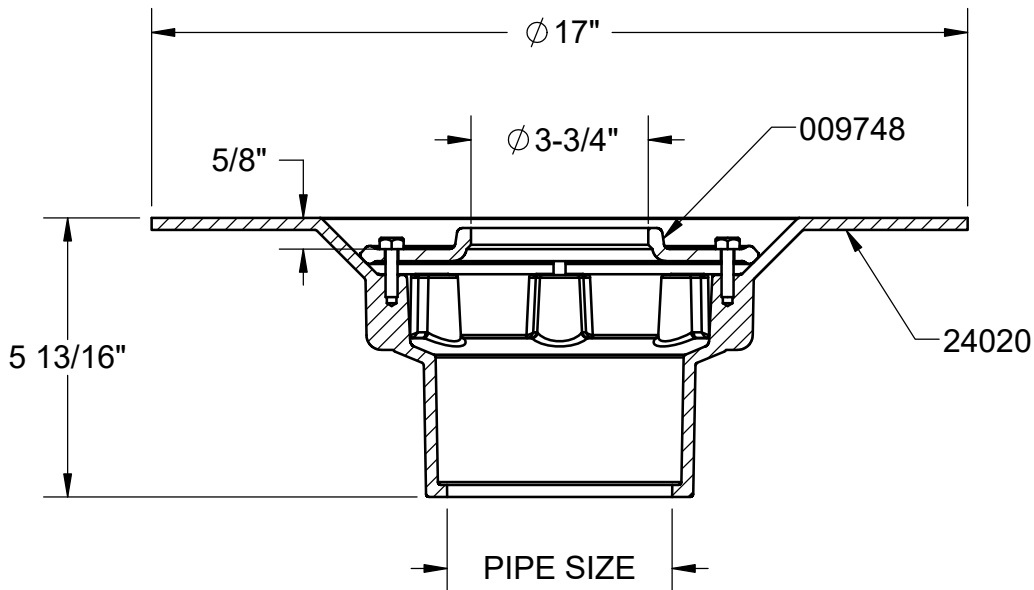
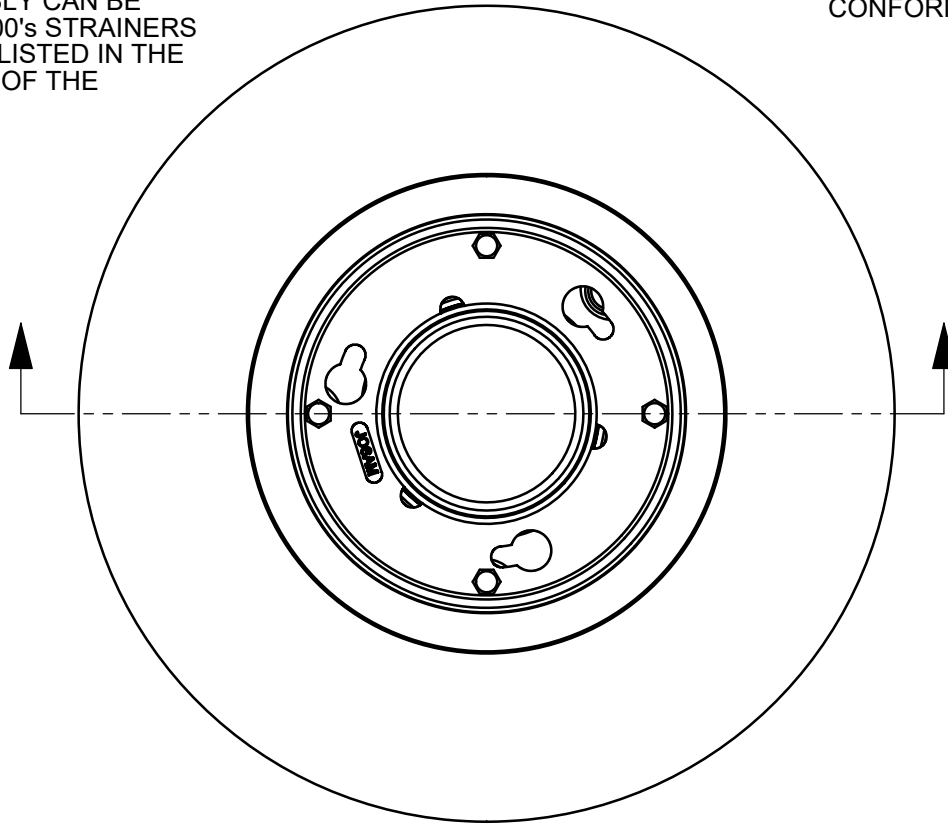

2"	PIPE SIZE	-ARE	ACID-RESISTING EPOXY
3"	PIPE SIZE	-92	GALVANIZED CAST IRON PARTS
4"	PIPE SIZE		

DATE OF LAST CHANGE: 05/21/20
 DIMENSIONS ARE SUBJECT TO MANUFACTURERS TOLERANCES AND CHANGE WITHOUT NOTICE. WE CAN ASSUME NO RESPONSIBILITY FOR USE OF SUPERSEDED OR VOID DATA.

JOSAM
 MICHIGAN CITY, INDIANA

NOTES

WARNING: Cancer and Reproductive Harm - www.P65Warnings.ca.gov